

BUILT-IN NUTRUNNERS DS line

Overview of the different construction sizes

Type	Models Maximum torque in Nm
> DS 26	0,5 1 2 4
> DS 34	2,5 5 10 15
> DS 44	2,5 5 10 20 35
> DS 57	25 50 70 90 140
> DS 80	220 300 420 500 600
> DS 80-130	900 1000 1500 2000 2400

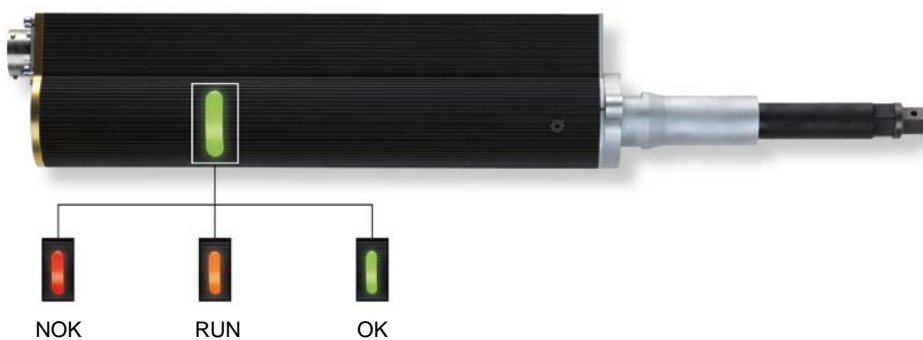

The illuminated field at the tool shows the tightening status.

The correct nutrunner for every tightening process

The requirements to a built-in nutrunner are multifaceted. The DS series offers you products which are especially configured for your application.

In the suitable size, with the suitable torque, in the required precision, with the suitable output.

Components of DS-nutrunners

- Maintenance-free brushless servo motor
- Robust housing out of stainless steel and aluminium
- Various motors and outputs

Advantages of DS-nutrunners

- Insensitive against electro-magnetic radiation due to digital data transfer
- Absolute measuring system enables positioning (MDW)
- Illuminated field for indication of the tightening status
- Simple programmable at the control unit or via external PC

MDW or SA – with or without torque transducer

DS-nutrunners of type MDW have a digital torque transducer. With this, the upcoming torque can be collected very precise. The accuracy-deviation is max. 0,5 % of the final value.

By DS-nutrunners of the type SA, the torque and the angle of rotation are collected via the motor. The accuracy-deviation here is max. 5 % of the final value.

Type	Torque measuring	Torque accuracy	Angle resolution
MDW	via digital torque transducer	0,5 %	> Data sheet
SA	via motor current	5 %	> Data sheet

Suitable control units for nutrunners of the DS series



Control unit	MultiBasic Blue TA	MultiBasic TA	MultiClassic TA	MultiPro TA
suitable for type	SA	SA	MDW	MDW

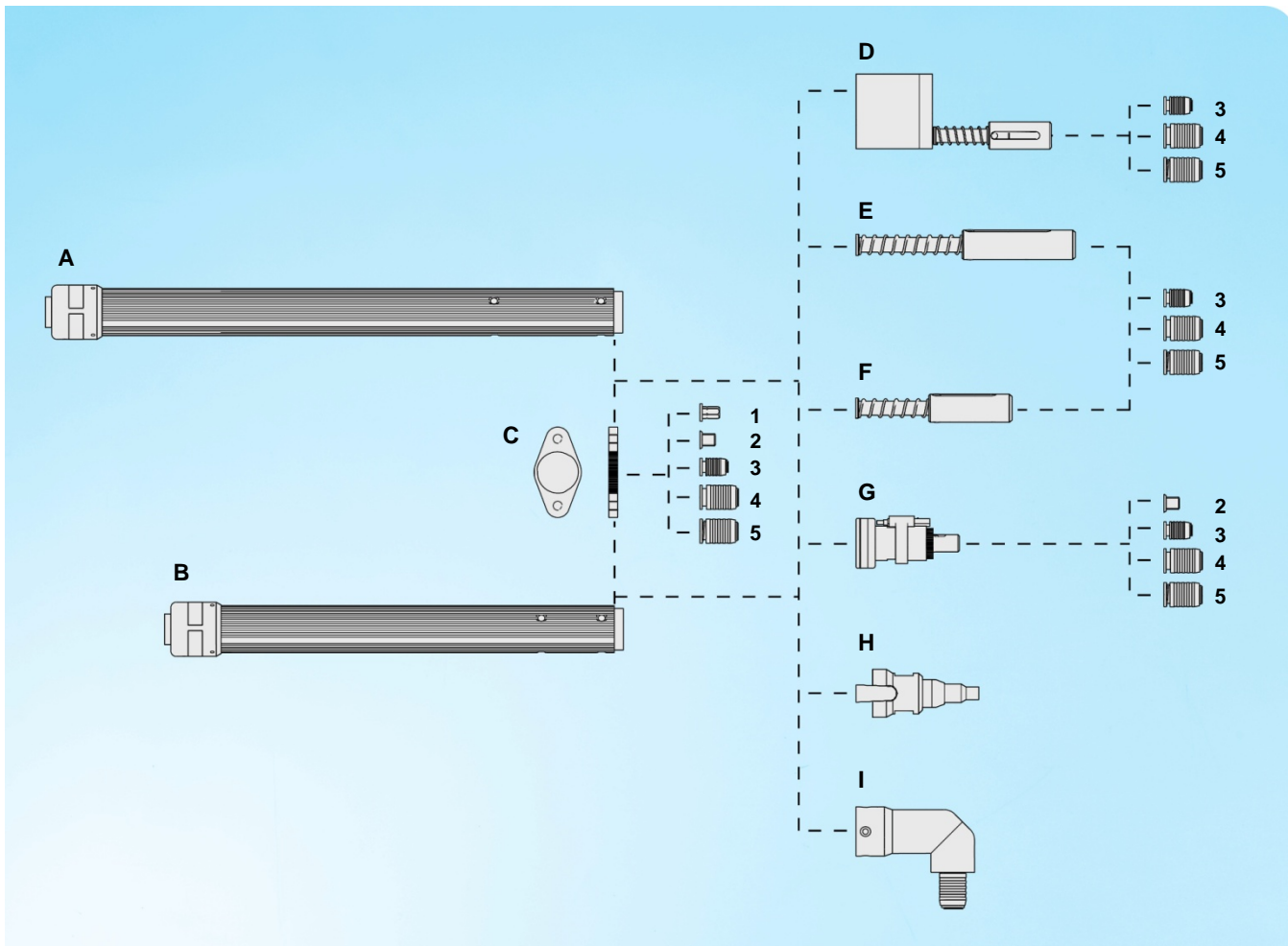

DS 26 series

A) DS 26 MDW with torque transducer



Type	Max. torque Nm	Application area Nm	Max. speed rpm	Angle resolution Degree [°]	Article number
DS 26 / 005 MDW	0,5	0,05 – 0,5	1450	3,7	DS-2260005
DS 26 / 01 MDW	1	0,2 – 1	1450	3,7	DS-2260010
DS 26 / 02 MDW	2	0,4 – 2	1020	2,6	DS-2260020
DS 26 / 04 MDW	4	0,8 – 4	400	1,0	DS-2260040

Torque accuracy 0,5 %, torque tolerance better 5 % according to ISO 5393

B) DS 26 SA without torque transducer



Type	Max. torque Nm	Application area Nm	Max. speed rpm	Angle resolution Degree [°]	Article number
DS 26 / 005 SA	0,5	0,05 – 0,5	1700	4,3	DS-2261005
DS 26 / 01 SA	1	0,2 – 1	1700	4,3	DS-2261010
DS 26 / 02 SA	2	0,4 – 2	820	2,1	DS-2261020
DS 26 / 04 SA	4	0,8 – 4	400	1,0	DS-2261040

Torque accuracy 5 %

C) Mounting flange

Type	Article number
Mounting flange	DS-2263000

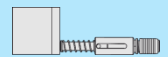
D) Output offset max. 2 Nm

Type	Article number
Output offset V1	DS-2263005

E/F) Spring output

Type	Article number
Spring output 20 mm	DS-2263010
Spring output 50 mm	DS-2263015

G) Self start output

Type	Article number
Self start with 5 mm spring deflexion	DS-2263020

H) Vacuum screw-retainer

Type	Article number
With electric supply unit	DS-2263895
With pneumatic supply unit	DS-2263896

I) Angle head

Type	Article number
Angle head (D6,3)	DS-2263025
Torque tolerance better 8 % according to ISO 5393	

1) Hexagon drive 1/4"

Type	Article number
Hexagon drive 1/4"	DS-2263725

2) Square drive 1/4"

Type	Article number
Square drive 1/4"	DS-2263730

3) Hexagonal quick change chuck B3

Type	Article number
Hexagonal quick change chuck B3	DS-2263720

4) Hexagonal quick change chuck B5,5

Type	Article number
Hexagonal quick change chuck B5,5	DS-2263715

5) Hexagonal quick change chuck D6,3

Type	Article number
Bit shaft precision-guide 13 mm	DS-2263705
Bit shaft precision-guide 24 mm	DS-2263710

Cable

Cable for interconnection between nutrunner and control system

Type	Cable length	Article number
Interconnecting cable DS26 / DSH26 DSP05	5 m	MK-2269005
Interconnecting cable DS26 DSP05 - heavy duty version	5 m	MK-2269105
Interconnecting cable DS26 DSP10 - heavy duty version	10 m	MK-2269110
Interconnecting cable DS26 DSP15 - heavy duty version	15 m	MK-2269115
Interconnecting cable DS26 DSP05 - heavy duty version, angled 90° right	5 m	MK-2269205
Interconnecting cable DS26 DSP10 - heavy duty version, angled 90° right	10 m	MK-2269210
Interconnecting cable DS26 DSP15 - heavy duty version, angled 90° right	15 m	MK-2269215
Interconnecting cable DS26 DSP05 - heavy duty version, angled 90° left	5 m	MK-2269305
Interconnecting cable DS26 DSP10 - heavy duty version, angled 90° left	10 m	MK-2269310
Interconnecting cable DS26 DSP15 - heavy duty version, angled 90° left	15 m	MK-2269315

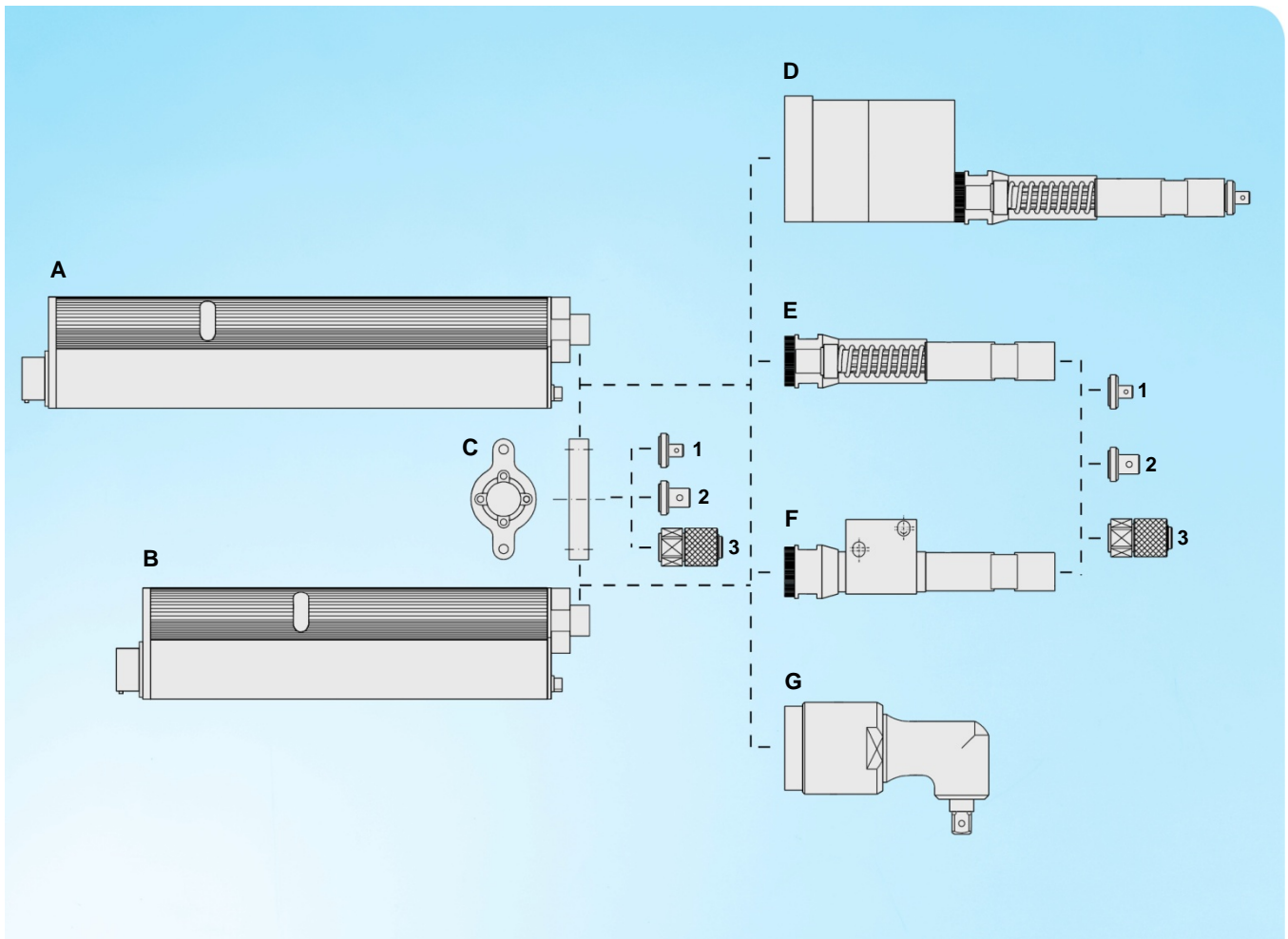

DS 34 series

A) DS 34 MDW with torque transducer

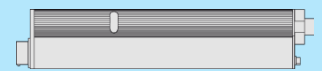

Type	Max. torque Nm	Application area Nm	Max. speed rpm	Angle resolution Degree [°]	Article number
DS 34 / 025 MDW	2,5	0,5 – 2,5	880	0,1	DS-2340025
DS 34 / 05 MDW	5	1 – 5	880	0,1	DS-2340050
DS 34 / 10 MDW	10	2 – 10	1540	0,1	DS-2340100
DS 34 / 15 MDW	15	3 – 15	1540	0,1	DS-2340150

Torque accuracy 0,5 %, torque tolerance better 5 % according to ISO 5393

B) DS 34 SA without torque transducer



Type	Max. torque Nm	Application area Nm	Max. speed rpm	Angle resolution Degree [°]	Article number
DS 34 / 025 SA	2,5	0,5 – 2,5	880	3,3	DS-2341025
DS 34 / 05 SA	5	1 – 5	880	3,3	DS-2341050
DS 34 / 10 SA	10	2 – 10	1540	1,7	DS-2341100
DS 34 / 15 SA	15	3 – 15	1540	1,7	DS-2341150

Torque accuracy 5 %

C) Mounting flange

Type	Article number
Mounting flange	DS-2343000

D) Output offset

Type	Article number
Output offset V1 (max. 10 Nm)	DS-2343005

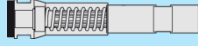
E) Spring output

Type	Article number
Spring output 30 mm	DS-2403025
Spring output 30 mm with depth initiator	DS-2403045
Spring output 50 mm	DS-2403030
Spring output 50 mm with depth initiator	DS-2403050

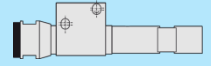
F) Spring output with self start initiator

Type	Article number
Self start 30 mm	DS-2403035
Self start 50 mm	DS-2403040

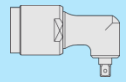
G) Angle head

Nutrunner MDW / SA	Max. speed rpm	Type	Article number
DS 34 / 025 WA	610	WA (3/8")	DS-2343010
DS 34 / 05 WA	610		
DS 34 / 10 WA	1070		
DS 34 / 15 WA	1070		

Torque tolerance better 8 % according to ISO 5393

1) Square drive 1/4"

Type	Article number
Square drive 1/4"	DS-2403715

2) Square drive 3/8"

Type	Article number
Square drive 3/8"	DS-2403720

**3) Hexagonal quick change chuck
D6,3**

Type	Article number
Bit shaft precision-guide 13 mm	DS-2403705
Bit shaft precision-guide 24 mm	DS-2403710

Cable

Cable for interconnection between nutrunner and control system

Type	Cable length	Article number
Interconnecting cable DS34 / DS44 / SMP300 DSP05	5 m	MK-2409005
Interconnecting cable DS34 / DS44 / SMP300 DSP10	10 m	MK-2409010
Interconnecting cable DS34 / DS44 / SMP300 DSP15	15 m	MK-2409015
Interconnecting cable DS34 / DS44 / SMP300 DSP05 - angled 90° right	5 m	MK-2409105
Interconnecting cable DS34 / DS44 / SMP300 DSP10 - angled 90° right	10 m	MK-2409110
Interconnecting cable DS34 / DS44 / SMP300 DSP15 - angled 90° right	15 m	MK-2409115
Interconnecting cable DS34 / DS44 / SMP300 DSP05 - angled 90° left	5 m	MK-2409205
Interconnecting cable DS34 / DS44 / SMP300 DSP10 - angled 90° left	10 m	MK-2409210
Interconnecting cable DS34 / DS44 / SMP300 DSP15 - angled 90° left	15 m	MK-2409215

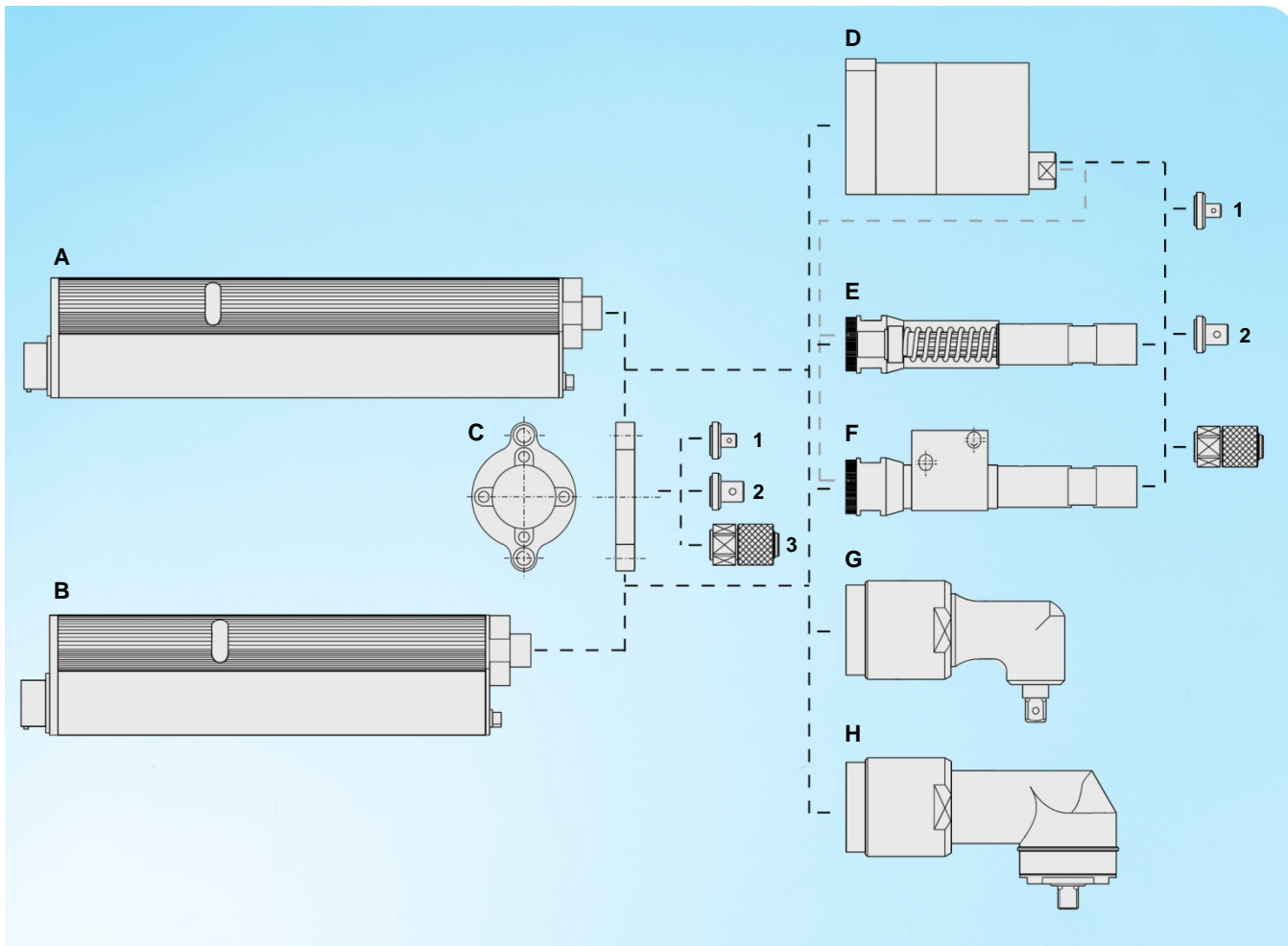

DS 44 series

A) DS 44 MDW with torque transducer



Type	Max. torque Nm	Application area Nm	Max. speed rpm	Angle resolution Degree [°]	Article number
DS 44 / 025 MDW	2,5	0,5 – 2,5	1300	0,1	DS-2440025
DS 44 / 05 MDW	5	1 – 5	1300	0,1	DS-2440050
DS 44 / 10 MDW	10	2 – 10	900	0,1	DS-2440100
DS 44 / 20 MDW	20	4 – 20	530	0,1	DS-2440200
DS 44 / 35 MDW	35	7 – 35	480	0,1	DS-2440350

Torque accuracy 0,5 %, torque tolerance better 5 % according to ISO 5393

B) DS 44 SA without torque transducer



Type	Max. torque Nm	Application area Nm	Max. speed rpm	Angle resolution Degree [°]	Article number
DS 44 / 05 SA	5	1 – 5	1300	3,3	DS-2441050
DS 44 / 10 SA	10	2 – 10	900	2,3	DS-2441100
DS 44 / 20 SA	20	4 – 20	530	1,4	DS-2441200
DS 44 / 35 SA	35	7 – 35	480	1,0	DS-2441350

Torque accuracy 5 %

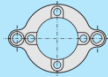
C) Mounting flange

Type	Article
Mounting flange	DS-2443000

D) Output offset

Type	Article number
Output offset V1 (max. 10 Nm)	DS-2443005

E) Spring output

Type	Article number
Spring output 30 mm	DS-2403025
Spring output 30 mm with depth initiator	DS-2403045
Spring output 50 mm	DS-2403030
Spring output 50 mm with depth initiator	DS-2403050

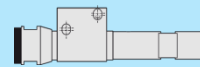
F) Spring output with self start initiator

Type	Article number
Self start 30 mm	DS-2403035
Self start 50 mm	DS-2403040

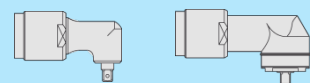
G/H) Angle head

Nutrunner MDW / SA	Max. speed rpm
DS 44 / 05 WA 20	900
DS 44 / 10 WA 20	625
DS 44 / 20 WA 20	370
DS 44 / 35 WA 40	250

Torque tolerance better 8 % according to ISO 5393

Type	Max. torque Nm	Article number
WA 20 (3/8")	20	DS-2443015
WA 40 (3/8")	40	DS-2443020

1) Square drive 1/4"

Type	Article number
Square drive 1/4"	DS-2403715

2) Square drive 3/8"

Type	Article number
Square drive 3/8"	DS-2403720

3) Hexagonal quick change chuck D6,3

Type	Article number
Bit shaft precision-guide 13 mm	DS-2403705
Bit shaft precision-guide 24 mm	DS-2403710

Cable

Cable for interconnection between nutrunner and control system

Type	Cable length	Article number
Interconnecting cable DS34 / DS44 / SMP300 DSP05	5 m	MK-2409005
Interconnecting cable DS34 / DS44 / SMP300 DSP10	10 m	MK-2409010
Interconnecting cable DS34 / DS44 / SMP300 DSP15	15 m	MK-2409015
Interconnecting cable DS34 / DS44 / SMP300 DSP05 - angled 90° right	5 m	MK-2409105
Interconnecting cable DS34 / DS44 / SMP300 DSP10 - angled 90° right	10 m	MK-2409110
Interconnecting cable DS34 / DS44 / SMP300 DSP15 - angled 90° right	15 m	MK-2409115
Interconnecting cable DS34 / DS44 / SMP300 DSP05 - angled 90° left	5 m	MK-2409205
Interconnecting cable DS34 / DS44 / SMP300 DSP10 - angled 90° left	10 m	MK-2409210
Interconnecting cable DS34 / DS44 / SMP300 DSP15 - angled 90° left	15 m	MK-2409215

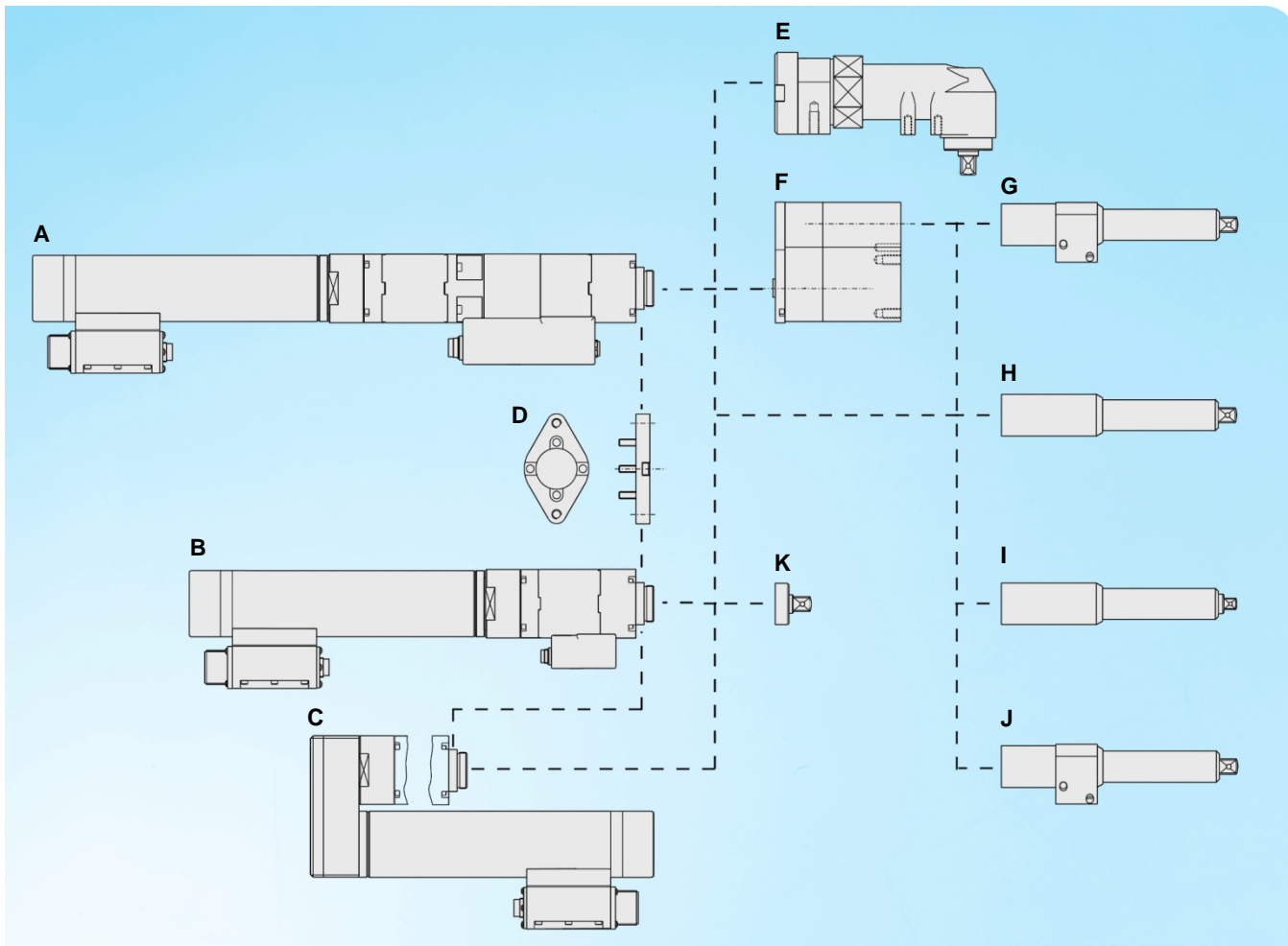

DS 57 series

A) DS 57 MDW with torque transducer

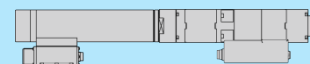

Type	Max. torque Nm	Application area Nm	Max. speed rpm	Angle resolution Degree [°]	Article number
DS 57 / 25 MDW	25	5 – 25	1050	0,1	DS-2570025
DS 57 / 50 MDW	50	10 – 50	1050	0,1	DS-2570050
DS 57 / 70 MDW	70	14 – 70	800	0,1	DS-2570070
DS 57 / 90 MDW	90	18 – 90	430	0,1	DS-2570090
DS 57 / 140 MDW	140	28 – 140	430	0,1	DS-2570140

Torque accuracy 0,5 %, torque tolerance better 5 % according to ISO 5393

B) DS 57 SA without torque transducer



Type	Max. torque Nm	Application area Nm	Max. speed rpm	Angle resolution Degree [°]	Article number
DS 57 / 25 SA	25	5 – 25	1050	4,5	DS-2571025
DS 57 / 50 SA	50	10 – 50	1050	4,5	DS-2571050
DS 57 / 70 SA	70	14 – 70	800	2,2	DS-2571070
DS 57 / 140 SA	140	28 – 140	430	1,2	DS-2571140

Torque accuracy 5 %

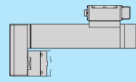
C) Motor offset

Type	Article number
Motor offset V2	DS-2573010

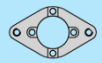
D) Mounting flange

Type	Article number
Mounting flange	DS-2573000

Always included, but not available for the variants E) and F)

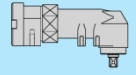
E) Angle head

Nutrunner MDW / SA	Max. speed rpm	Type	Article number
DS 57 / 50 WA	1000	WA (1/2", max. 130 Nm)	DS-2573015
DS 57 / 70 WA	760		
DS 57 / 140 WA	420		

Torque tolerance better 8 % according to ISO 5393

F) Output offset

Type	Article number
Output offset V1	DS-2573005

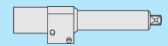
**G) Spring output 50 mm
with self start initiator**

Type	Article number
Self start, square drive 1/2"	DS-2573045
Self start, square drive 3/8"	DS-2573050

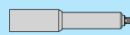
**H) Spring output with
square drive 1/2"**

Type	Article number
Spring output 50 mm	DS-2573025
Spring output 100 mm	DS-2573035

**I) Spring output with
square drive 3/8" (max. 50 Nm)**

Type	Article number
Spring output 50 mm	DS-2573030
Spring output 100 mm	DS-2573040

**J) Spring output 50 mm
with depth initiator**

Type	Article number
Depth initiator, square drive 1/2"	DS-2573055
Depth initiator, square drive 3/8" *	DS-2573065

* max. 50 Nm

**K) Stump output with
square drive 1/2"**

Type	Article number
Stump output ST	DS-2573020

Cable set

Cables for interconnection between nutrunner and control system

Type	Cable length	Article number
Cable set DS57 / QMP80 / SMP400 DSP05	5 m	MK-0809005
Cable set DS57 / QMP80 / SMP400 DSP10	10 m	MK-0809010
Cable set DS57 / QMP80 / SMP400 DSP15	15 m	MK-0809015
Cable set DS57 / QMP80 / SMP400 DSP05 - with shielding	5 m	MK-0809105
Cable set DS57 / QMP80 / SMP400 DSP10 - with shielding	10 m	MK-0809110
Cable set DS57 / QMP80 / SMP400 DSP15 - with shielding	15 m	MK-0809115

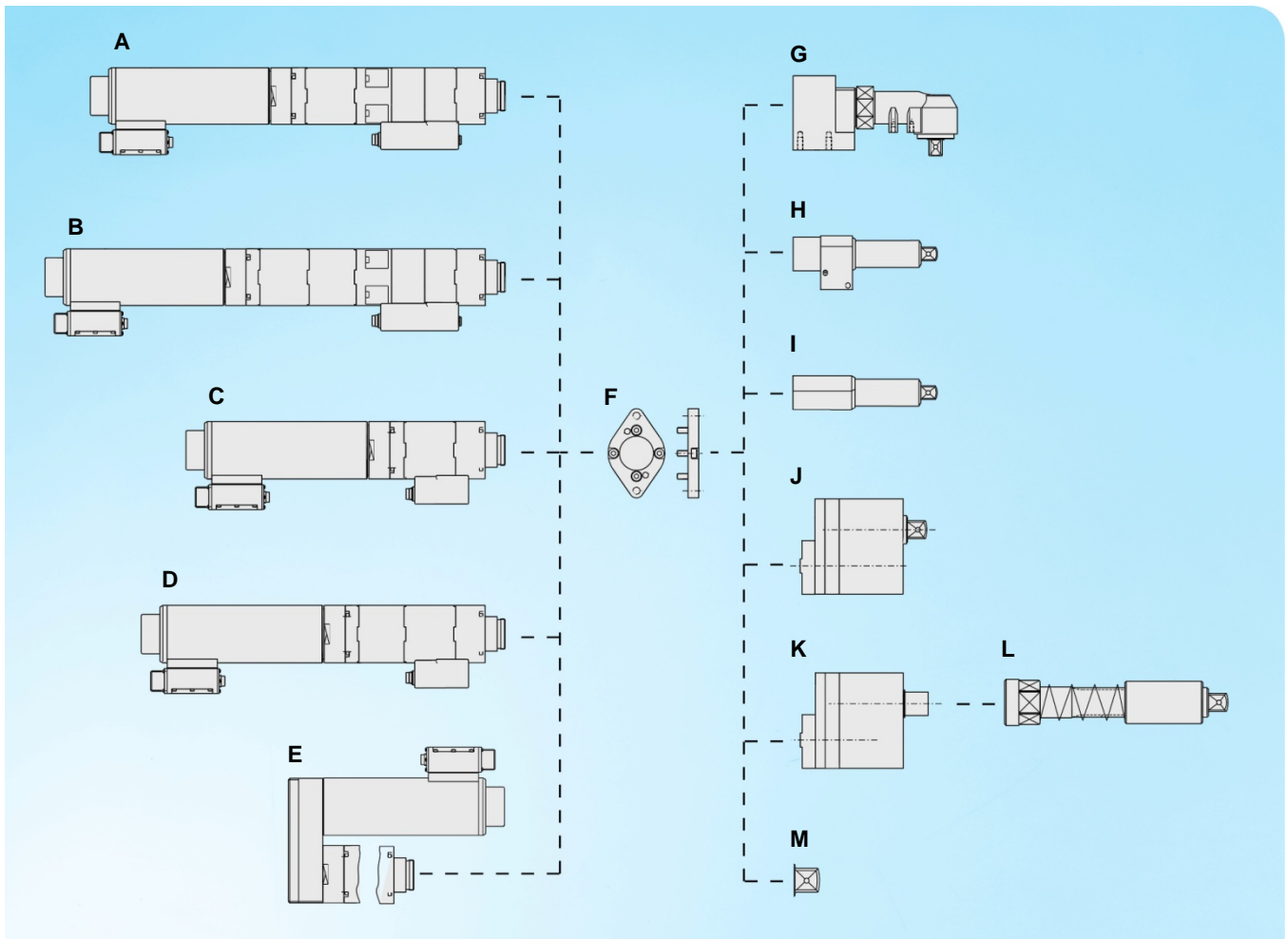

DS 80 series

A) DS 80 MDW (220/300 Nm) with torque transducer



Type	Max. torque Nm	Application area Nm	Max. speed rpm	Angle resolution Degree [°]	Article number
DS 80 / 220 MDW	220	44 – 220	320	0,1	DS-2800022
DS 80 / 300 MDW	300	60 – 300	320	0,1	DS-2800030

Torque accuracy 0,5 %, torque tolerance better 5 % according to ISO 5393

B) DS 80 MDW (420/500/600 Nm) with torque transducer Booster gear unit



Type	Max. torque Nm	Application area Nm	Max. speed rpm	Angle resolution Degree [°]	Article number
DS 80 / 420 MDW	420	84 – 420	160	0,1	DS-2800042
DS 80 / 500 MDW	500	100 – 500	160	0,1	DS-2800050
DS 80 / 600 MDW	600	120 – 600	160	0,1	DS-2800060

Torque accuracy 0,5 %, torque tolerance better 5 % according to ISO 5393

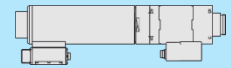
C) DS 80 SA (220/300 Nm) without torque transducer

Type	Max. torque Nm	Application area Nm	Max. speed rpm	Angle resolution Degree [°]	Article number
DS 80 / 220 SA	220	44 – 220	320	1,2	DS-2801022
DS 80 / 300 SA	300	60 – 300	320	1,2	DS-2801030

Torque accuracy 5 %

**D) DS 80 SA (420/500/600 Nm) without torque transducer
Booster gear unit**

Type	Max. torque Nm	Application area Nm	Max. speed rpm	Angle resolution Degree [°]	Article number
DS 80 / 420 SA	420	84 – 420	160	1,0	DS-2801042
DS 80 / 500 SA	500	100 – 500	160	1,0	DS-2801050
DS 80 / 600 SA	600	120 – 600	160	1,0	DS-2801060

Torque accuracy 5 %

E) Motor offset

Type	Article number
Motor offset V2	DS-2803005

F) Mounting flange

Type	Article number
Mounting flange	DS-2803000

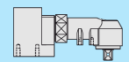
G) Angle head

Nutrunner MDW / SA	Max. speed rpm	Type	Article number
DS 80 / 220 WA	200	WA (3/4")	DS-2803010

Torque tolerance better 8 % according to ISO 5393

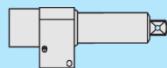
**H) Spring output with self start,
square drive 3/4"**

Spring deflexion	Article number
50 mm	DS-2803050
70 mm	DS-2803055
100 mm	DS-2803065
150 mm	DS-2803070

**I) Spring output with
square drive 3/4"**

Spring deflexion	Article number
50 mm	DS-2803030
70 mm	DS-2803035
100 mm	DS-2803040
150 mm	DS-2803045

J) Output offset with stump output, square drive 1"

Type	Article number
Output offset V1 ST	DS-2803015

K) Output offset
(for using with spring output)

Type	Article number
Output offset V1 (3K)	DS-2803020

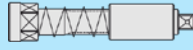
L) Spring output with square drive 1" (for output offset)

Type	Article number
Spring output 50 mm (3K)	DS-2803075

M) Stump output with square drive 3/4"

Type	Article number
Stump output ST	DS-2803025

Cable set

Cables for interconnection between nutrunner and control system

Type	Cable length	Article number
Cable set DS80 / QMP100/140 / SMP500 DSP05	5 m	MK-1009005
Cable set DS80 / QMP100/140 / SMP500 DSP10	10 m	MK-1009010
Cable set DS80 / QMP100/140 / SMP500 DSP15	15 m	MK-1009015
Cable set DS80 / QMP100/140 / SMP500 DSP05 - with shielding	5 m	MK-1009105
Cable set DS80 / QMP100/140 / SMP500 DSP10 - with shielding	10 m	MK-1009110
Cable set DS80 / QMP100/140 / SMP500 DSP15 - with shielding	15 m	MK-1009115

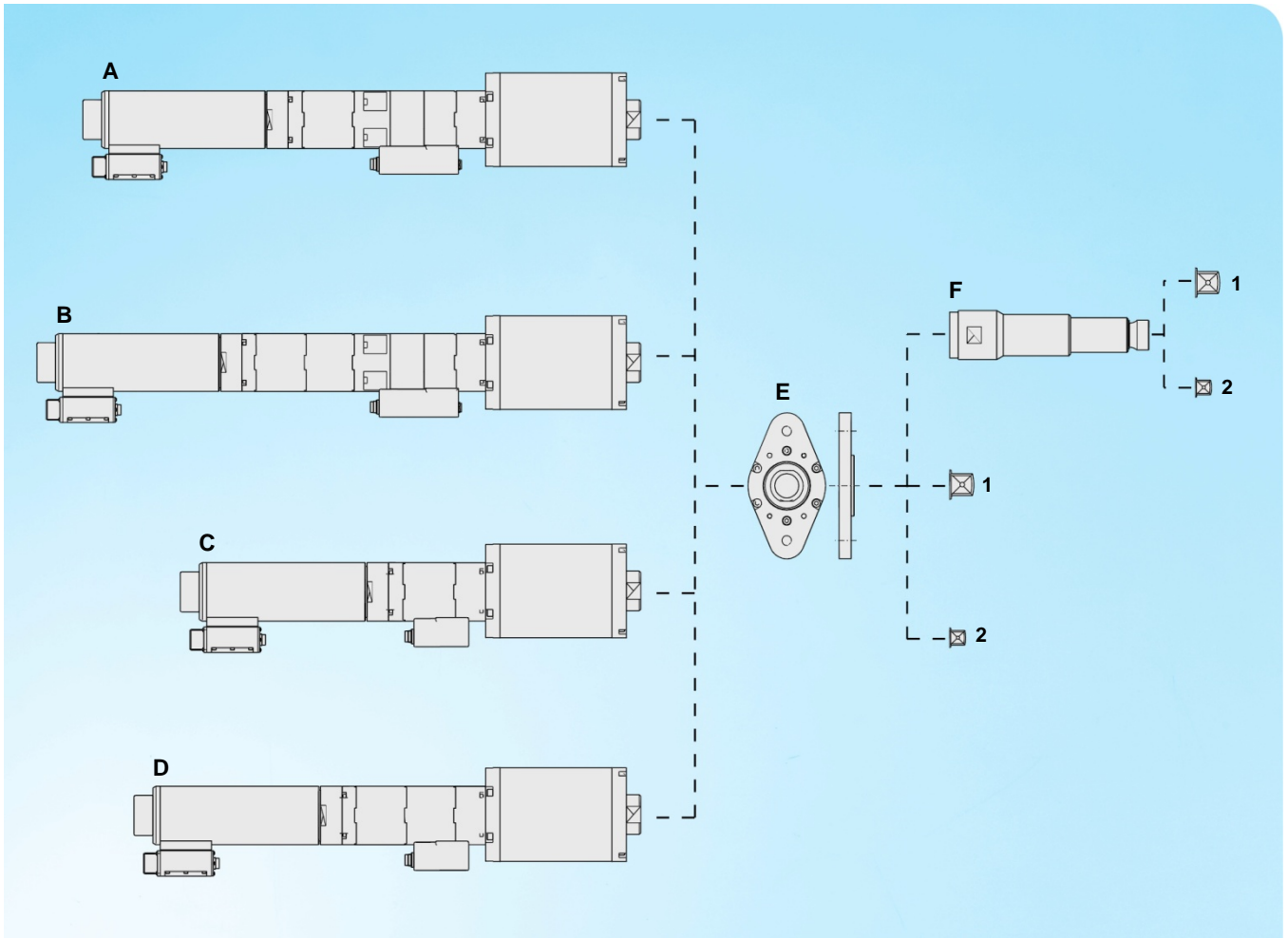

DS 80-130 series

A) DS 80-130 MDW (900/1000 Nm) with torque transducer



Type	Max. torque Nm	Application area Nm	Max. speed rpm	Angle resolution Degree [°]	Article number
DS 80-130 / 900 MDW	900	180–900	100	0,1	DS-2800090
DS 80-130 / 1000 MDW	1000	200–1000	75	0,1	DS-2800100

Torque accuracy 0,5 %, torque tolerance better 5 % according to ISO 5393

B) DS 80-130 MDW (1500/2000/2400 Nm) with torque transducer Booster gear unit



Type	Max. torque Nm	Application area Nm	Max. speed rpm	Angle resolution Degree [°]	Article number
DS 80-130 / 1500 MDW	1500	300–1500	75	0,1	DS-2800150
DS 80-130 / 2000 MDW	2000	400–2000	37	0,1	DS-2800200
DS 80-130 / 2400 MDW	2400	480–2400	37	0,1	DS-2800240

Torque accuracy 0,5 %, torque tolerance better 5 % according to ISO 5393

C) DS 80-130 SA (900/1000 Nm) without torque transducer

Type	Max. torque Nm	Application area Nm	Max. speed rpm	Angle resolution Degree [°]	Article number
DS 80-130 / 900 SA	900	180–900	100	1,0	DS-2801090
DS 80-130 / 1000 SA	1000	200–1000	75	1,0	DS-2801100

Torque accuracy 5 %

**D) DS 80-130 SA (1500/2000/2400 Nm) without torque transducer
Booster gear unit**

Type	Max. torque Nm	Application area Nm	Max. speed rpm	Angle resolution Degree [°]	Article number
DS 80-130 / 1500 SA	1500	300–1500	75	1,0	DS-2801150
DS 80-130 / 2000 SA	2000	400–2000	37	1,0	DS-2801200
DS 80-130 / 2400 SA	2400	480–2400	37	1,0	DS-2801240

Torque accuracy 5 %

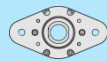
E) Mounting flange

Type	Article number
Mounting flange	DS-2803001

F) Spring output

Type	Article number
Spring output 50 mm	DS-2803080

1) Square drive 1,5"

Type	Article number
Square drive 1,5" (up to 2400 Nm)	DS-2803110

2) Square drive 1"

Type	Article number
Square drive 1" (up to 1000 Nm)	DS-2803105

Cable set

Cables for interconnection between nutrunner and control system

Type	Cable length	Article number
Cable set DS80 / QMP100/140 / SMP500 DSP05	5 m	MK-1009005
Cable set DS80 / QMP100/140 / SMP500 DSP10	10 m	MK-1009010
Cable set DS80 / QMP100/140 / SMP500 DSP15	15 m	MK-1009015
Cable set DS80 / QMP100/140 / SMP500 DSP05 - with shielding	5 m	MK-1009105
Cable set DS80 / QMP100/140 / SMP500 DSP10 - with shielding	10 m	MK-1009110
Cable set DS80 / QMP100/140 / SMP500 DSP15 - with shielding	15 m	MK-1009115

Technical data

Nutranners of the DS series in equal measure are suitable to be used in manual working stations as well as in automatic stations.

Available in the execution MDW, the torque measurement is made directly at the output by a transducer, or in the execution SA, the torque measurement is made indirect by the motor.

The tightening tools consist out of a robust mechanic with servo drive technology and gearbox unit with precision gearwheel bearing.



- Torque control, angle of rotation control and signal control are integrated
- Integrated digital parameter memory module enables error-free setup
- Monitoring with envelope technology and windowing (tightening control system)
- Thanks to the torque transducer with consistent accuracy, only one measuring range is necessary
- Powerful, maintenance-free EC motor with infinitely variable speed control, CW / CCW
- Status indication (RUN, OK, NOK) directly at the nutrunner

DS 26 series	MDW SA			
Models, max. torque	0,5 Nm	1 Nm	2 Nm	4 Nm
max. speed (execution MDW)	1450 rpm	1450 rpm	1020 rpm	400 rpm
max. speed (execution SA)	1700 rpm	1700 rpm	820 rpm	400 rpm

DS 34 series	MDW SA			
Models, max. torque	2,5 Nm	5 Nm	10 Nm	15 Nm
max. speed	880 rpm	880 rpm	1540 rpm	1540 rpm
max. speed (with angle output)	610 rpm	610 rpm	1070 rpm	1070 rpm

DS 44 series	MDW SA				
Models, max. torque	2,5 Nm	5 Nm	10 Nm	20 Nm	35 Nm
max. speed	1300 rpm	1300 rpm	900 rpm	530 rpm	480 rpm
max. speed (with angle output)	---	900 rpm	625 rpm	370 rpm	250 rpm

DS 57 series	MDW SA				
Models, max. torque	25 Nm	50 Nm	70 Nm	90 Nm	140 Nm
max. speed	1050 rpm	1050 rpm	800 rpm	430 rpm	430 rpm
max. speed (with angle output)	---	1000 rpm	760 rpm	---	420 rpm

DS 80 series	MDW SA				
Models, max. torque	220 Nm	300 Nm	420 Nm	500 Nm	600 Nm
max. speed	320 rpm	320 rpm	160 rpm	160 rpm	160 rpm
max. speed (with angle output)	200 rpm	---	---	---	---

DS 80-130 series	MDW SA				
Models, max. torque	900 Nm	1000 Nm	1500 Nm	2000 Nm	2400 Nm
max. speed	100 rpm	75 rpm	75 rpm	37 rpm	37 rpm

Accessories

- Diverse motor and output variants, crow foos as well as individual technical solutions
- Socket boxes, handling equipment
- Complete workstations

Technical drawings DS 26 series

DS 26 MDW

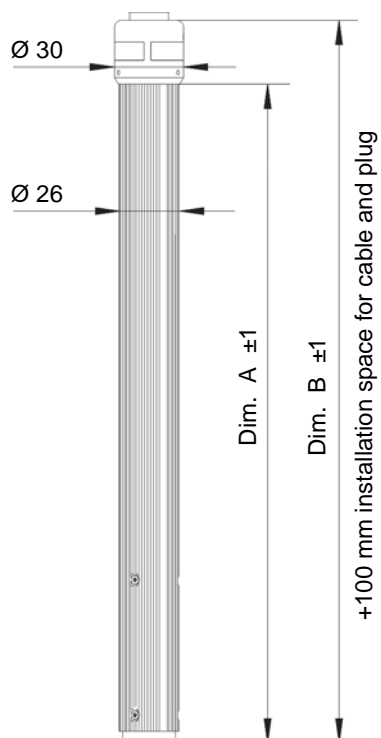

DS 26 SA

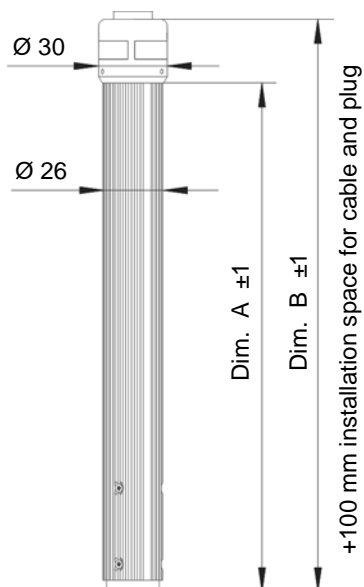

Type MDW	Dim. A mm	Dim. B mm	Type SA	Dim. A mm	Dim. B mm
DS 26 / 005 MDW	217	245	DS 26 / 005 SA	179	207
DS 26 / 01 /02 MDW	235	263	DS 26 / 01 /02 SA	197	225
DS 26 / 04 MDW	242	270	DS 26 / 04 SA	200	228

Mounting flange

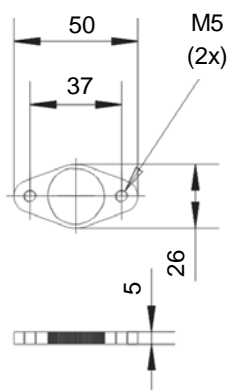

Spring output 20 mm

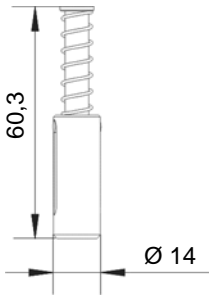

Spring output 50 mm

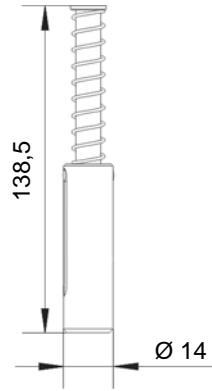

Self start

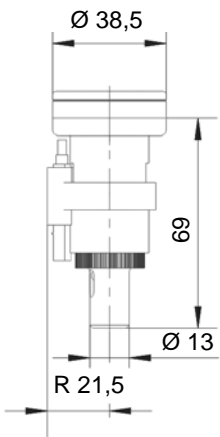

Angle head

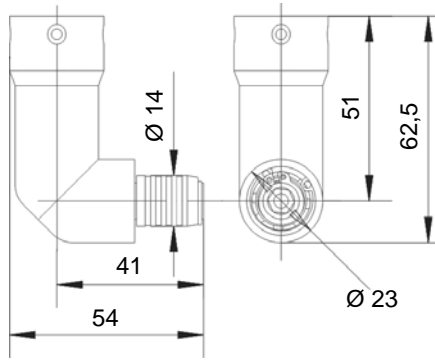

WA with quick change chuck
DIN 3126 D6,3

Vacuum screw-retainer

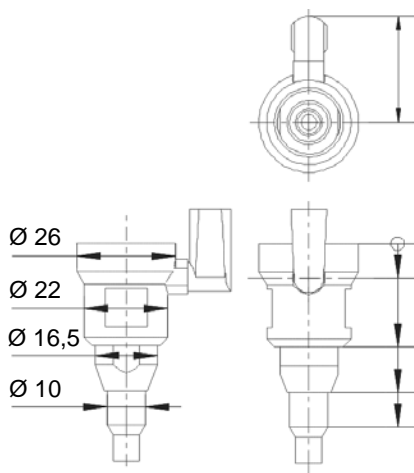

Nozzle to customer requirements

Hexagonal drive 1/4" DIN 3126 C6,3

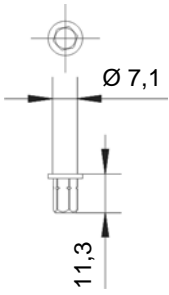

Square drive 1/4" DIN 3121 F6,3

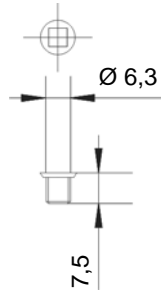

Hexagonal quick change chuck DIN 3126 B3

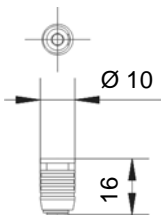

Hexagonal quick change chuck DIN 3126 B5,5

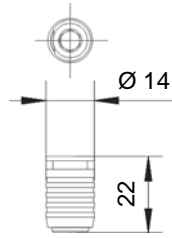

Hexagonal quick change chuck DIN 3126 D6,3

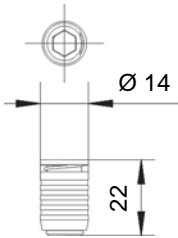

Interconnecting cable 90° angled

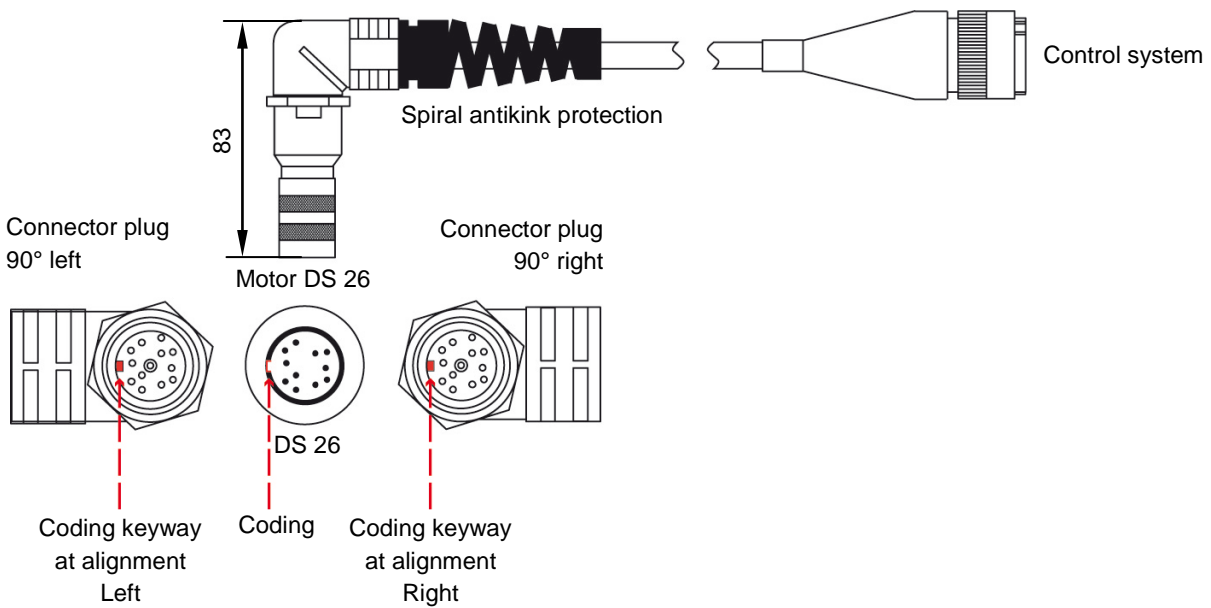

Technical drawings DS 34 series

DS 34 MDW

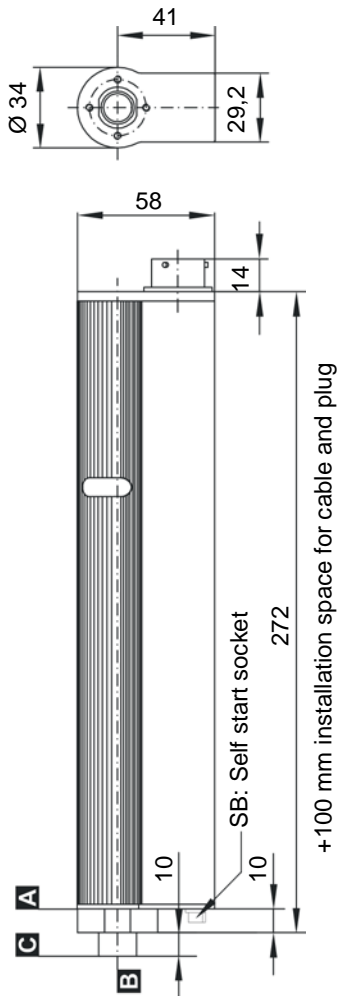

DS 34 SA

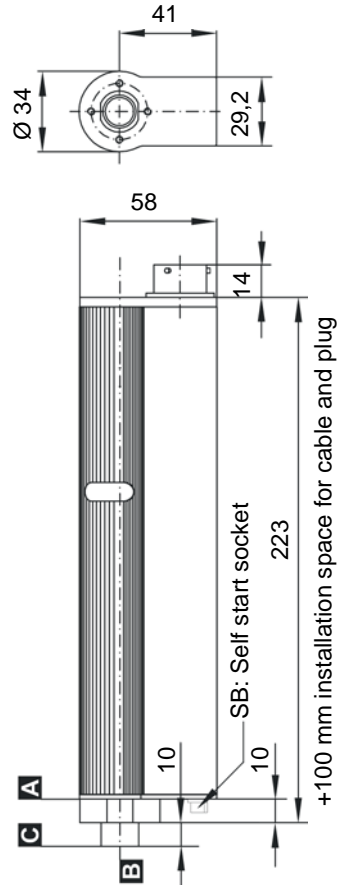

Mounting flange

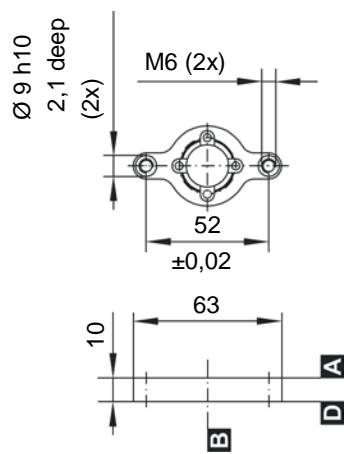

Angle head

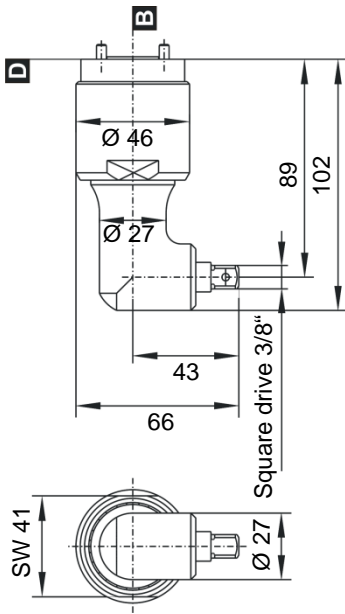

Output offset

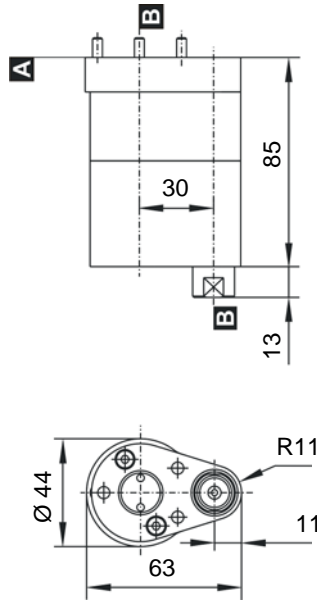

Spring output

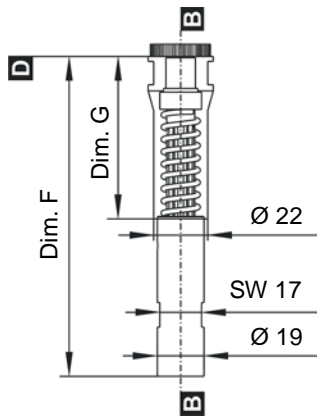

Self start

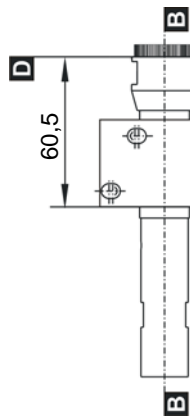

Spring deflexion	Dimension F mm	Dimension G mm
30 mm	130	66
50 mm	150	86

Square drive DIN 3121 F6,3

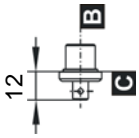

Square drive DIN 3121 F10

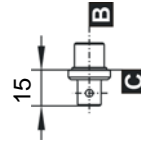

Hexagonal quick change chuck DIN 3126 D6,3

Bit shaft precision-guide 24 mm

Bit shaft precision-guide 13 mm

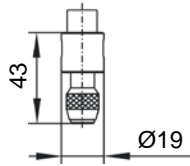
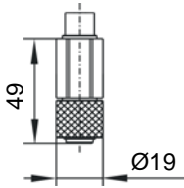

Interconnecting cable 90° angled

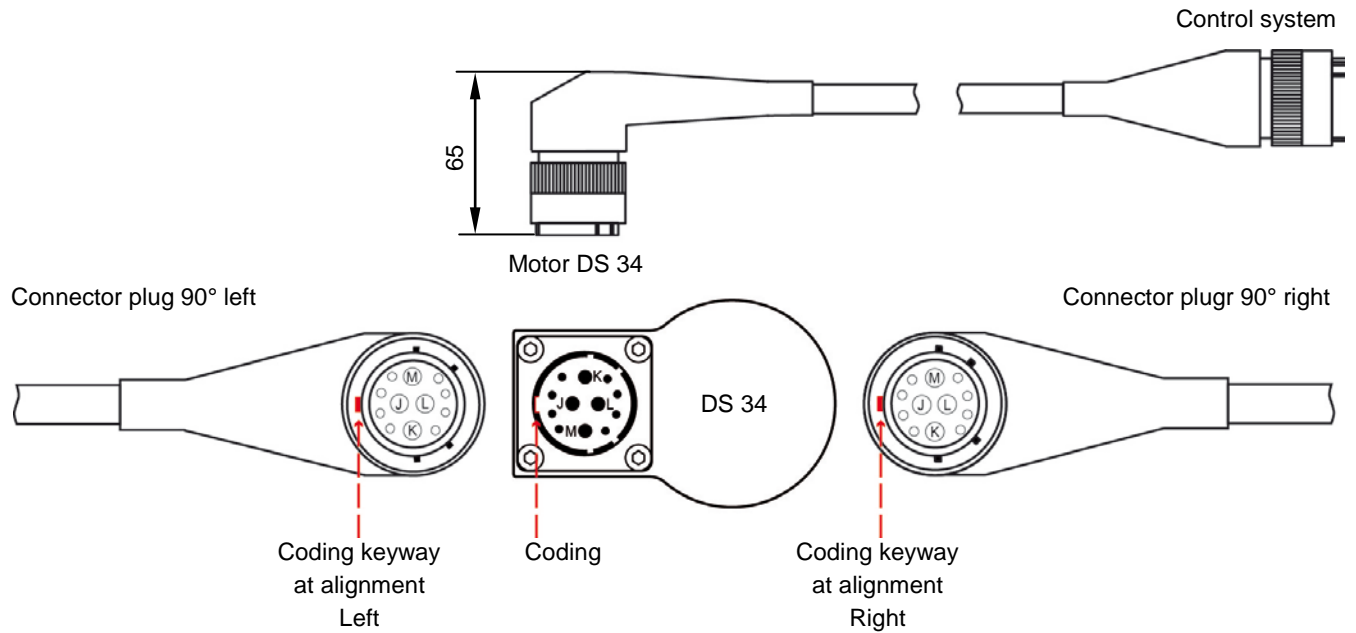

Technical drawings DS 44 series

DS 44 MDW

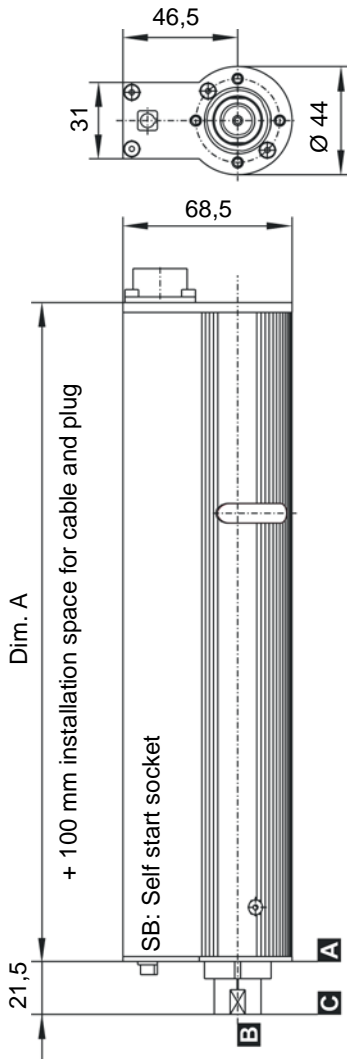

DS 44 SA

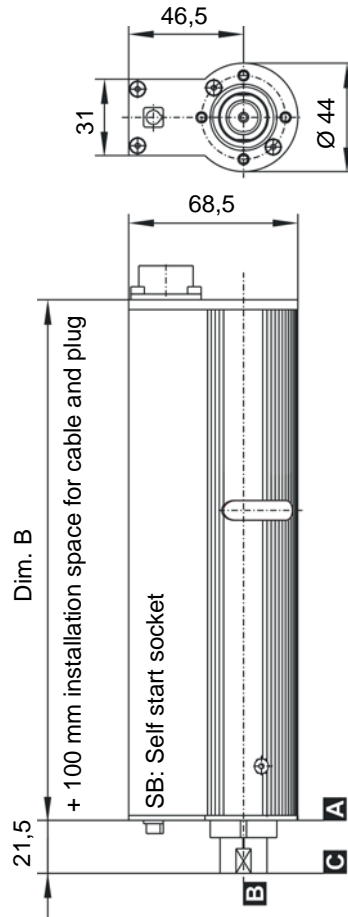

Type	Dimension A mm	Dimension B mm
DS 44 / 05 / 10 / 20	267,5	211,5
DS 44 / 35	348,5	292,5

Mounting flange

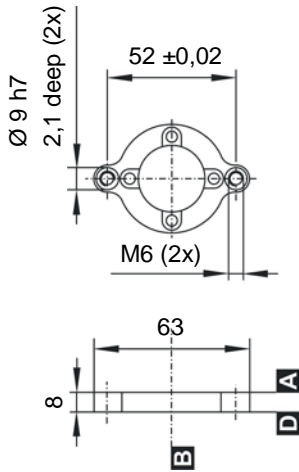

Angle head 20 Nm

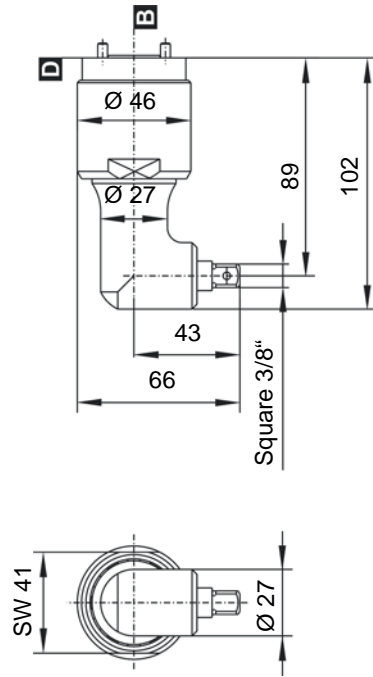

Angle head 40 Nm

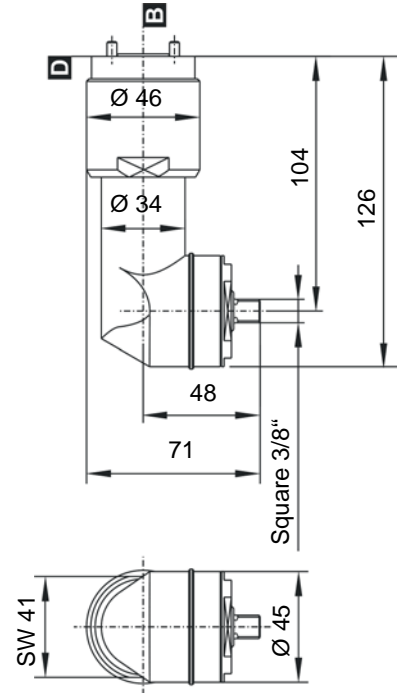

Output offset

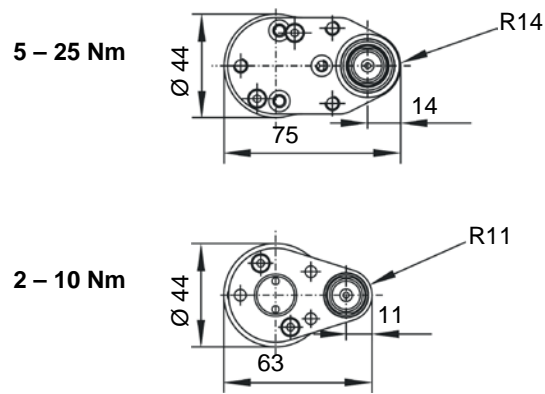
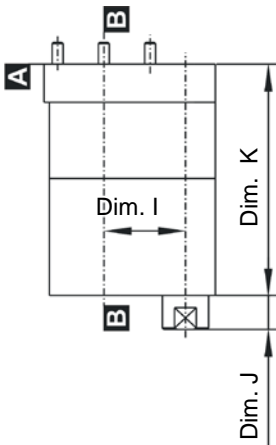

Type	Dimension I mm	Dimension J mm	Dimension K mm
2 – 10 Nm	30	13	85
5 – 25 Nm	35	12	106

Spring output

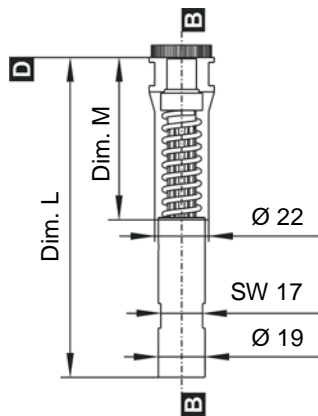

Self start

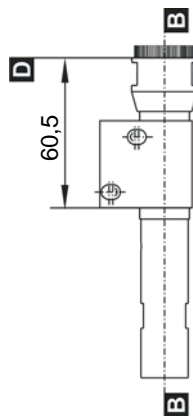

Type	Dimension L mm	Dimension M mm
30 mm	130	66
50 mm	150	85

Square drive DIN 3121 F6,3

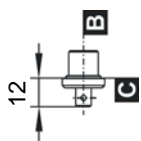

Square drive DIN 3121 F10

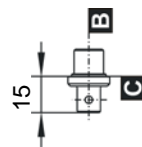

Hexagonal quick change chuck DIN 3126 D6,3

Bit shaft precision-guide 24 mm

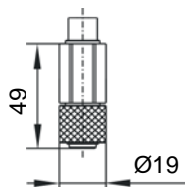

Bit shaft precision-guide 13 mm

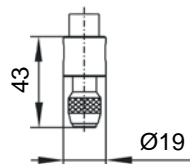

Interconnecting cable 90° angled

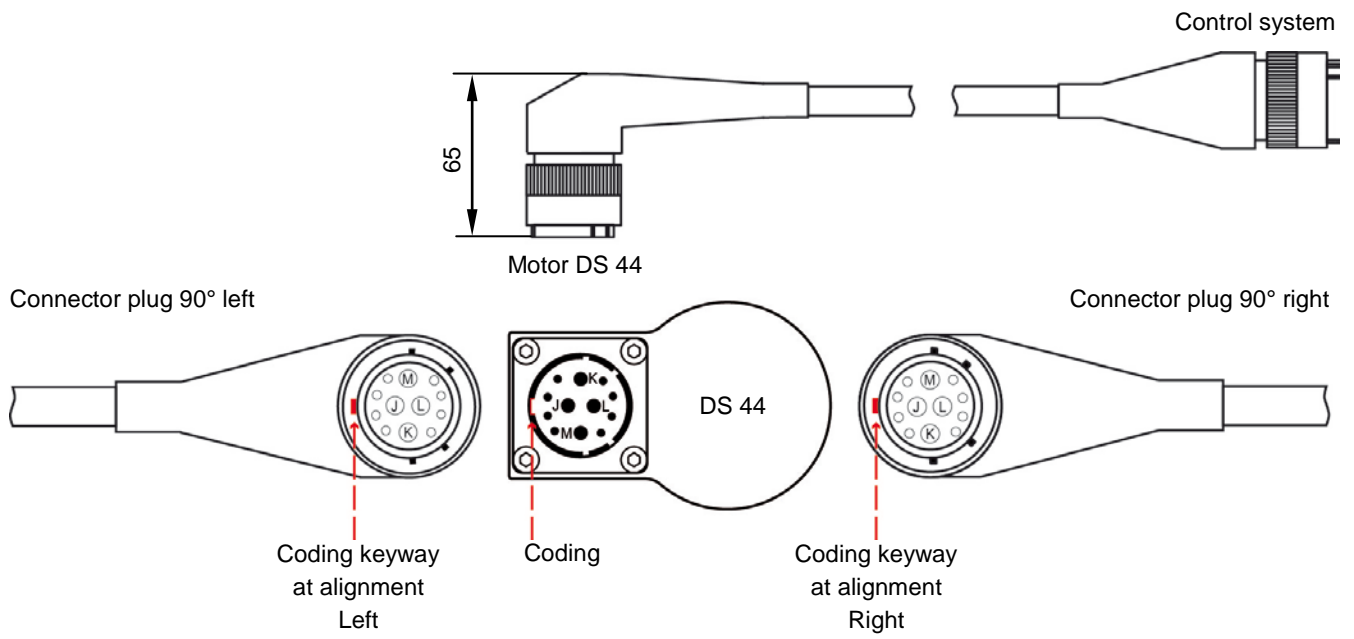

Technical drawings DS 57 series

DS 57 MDW

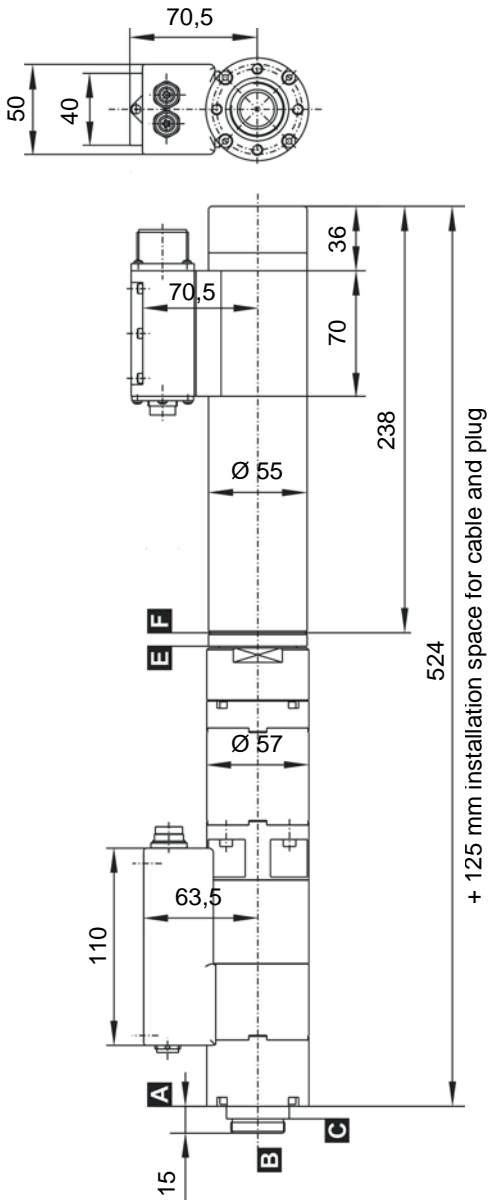

DS 57 SA

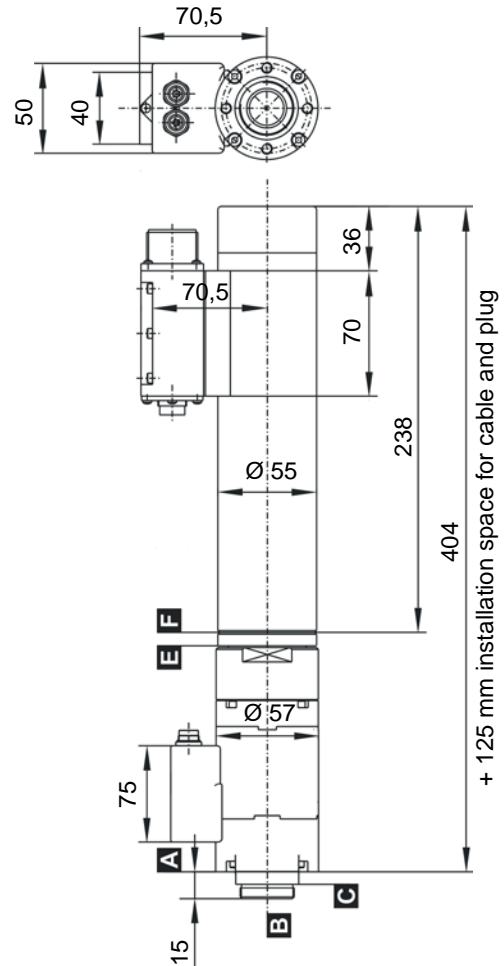

Mounting flange

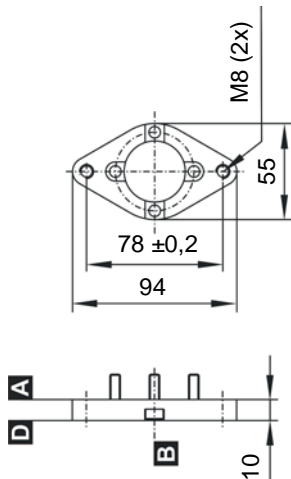

Motor offset

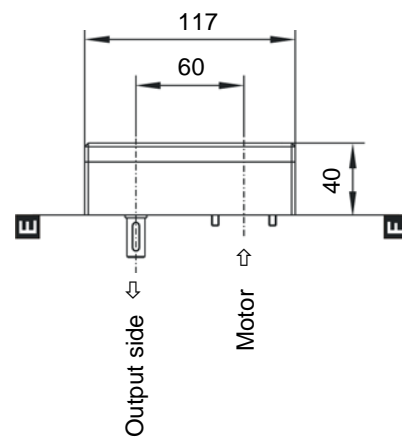

Angle head WA

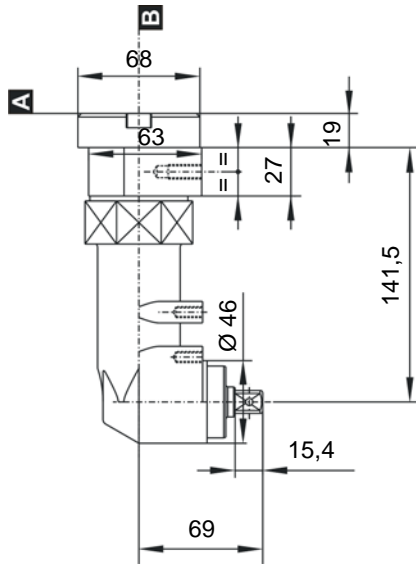

Output offset

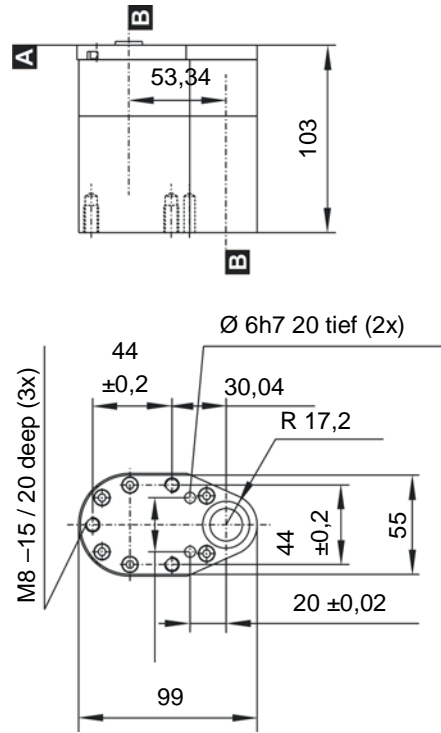

Spring output 1/2" square drive

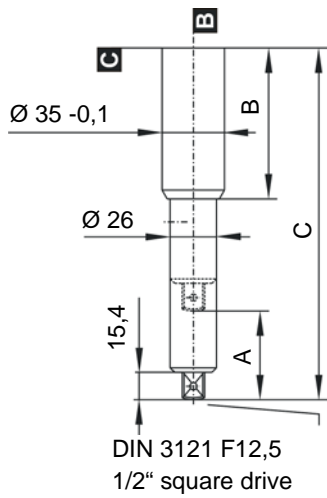

Spring output 3/8" square drive

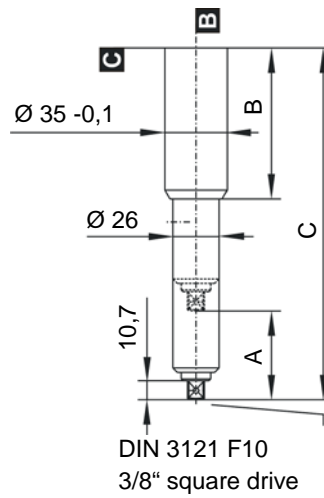

Type (spring deflexion)	A mm	B mm	C mm
F50	50	85	198
F100	100	135	298

Stump output

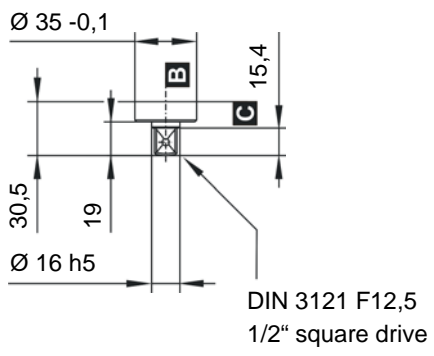

Self start

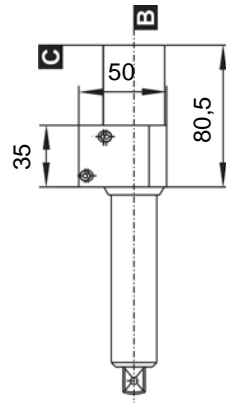

Technical drawings DS 80 series

DS 80 MDW (220/300 Nm)

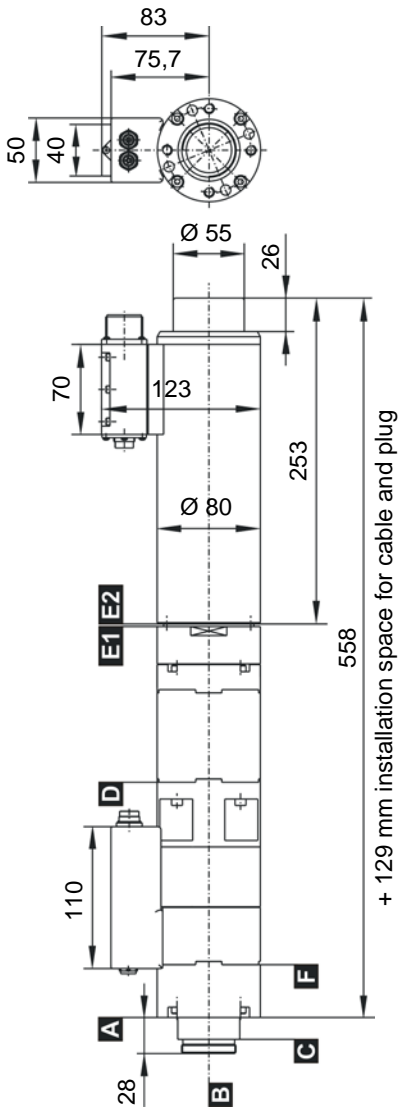

DS 80 SA (220/300 Nm)

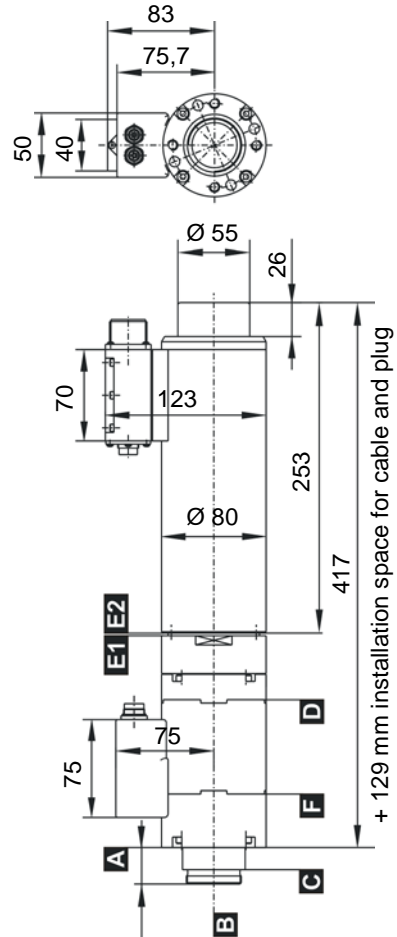

DS 80 MDW (420/500/600 Nm)

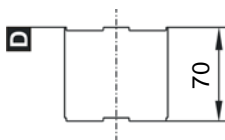

Additional
gear stage
(Booster gear unit)

DS 80 SA (420/500/600 Nm)

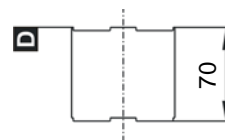

Additional
gear stage
(Booster gear unit)

Mounting flange

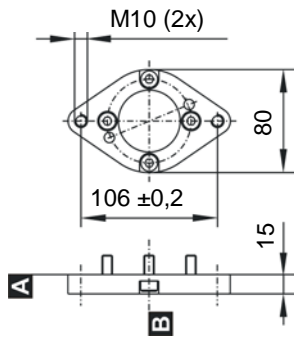

Output offset

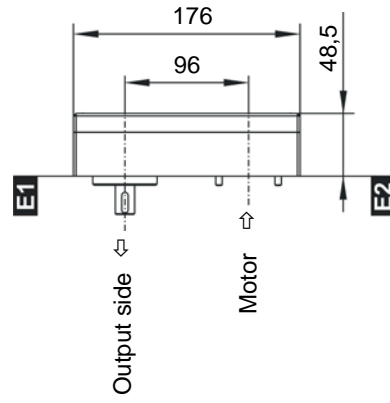

Angle head

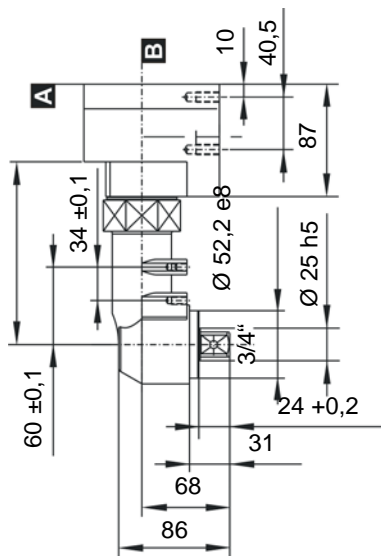

Self start

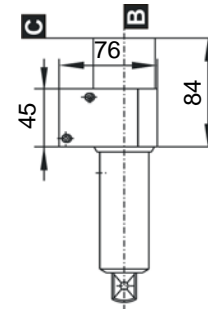

Stump output 3/4" square drive

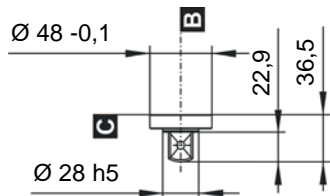

DIN 3121 F20
3/4" square drive

Spring output 3/4" square drive

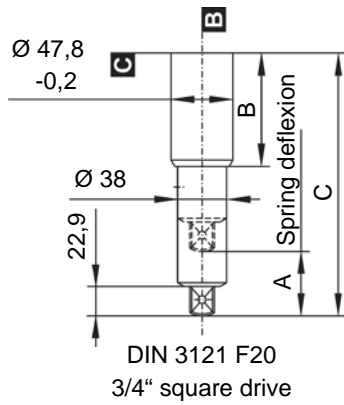

Spring output 1" square drive

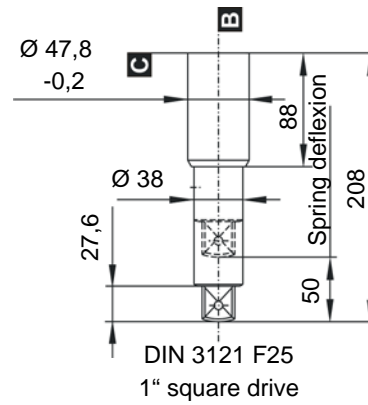

Type (spring deflexion)	A mm	B mm	C mm
F50	50	88	204
F70	70	130	268
F100	100	152	321,5
F150	150	212,2	432

Output offset (for using with spring output)

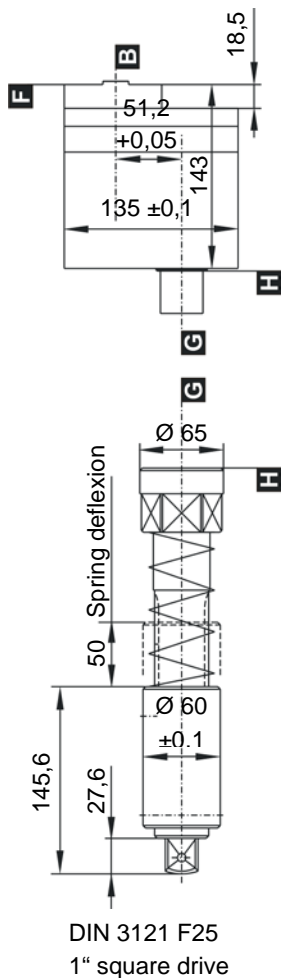

Output offset with stump output

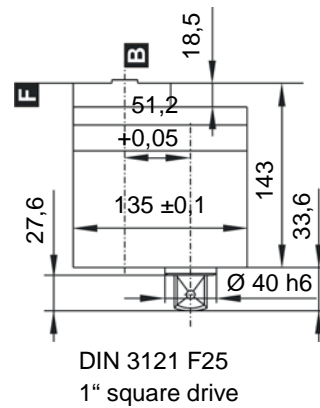

Technical drawings DS 80-130 series

DS 80-130 MDW (900/1000 Nm)

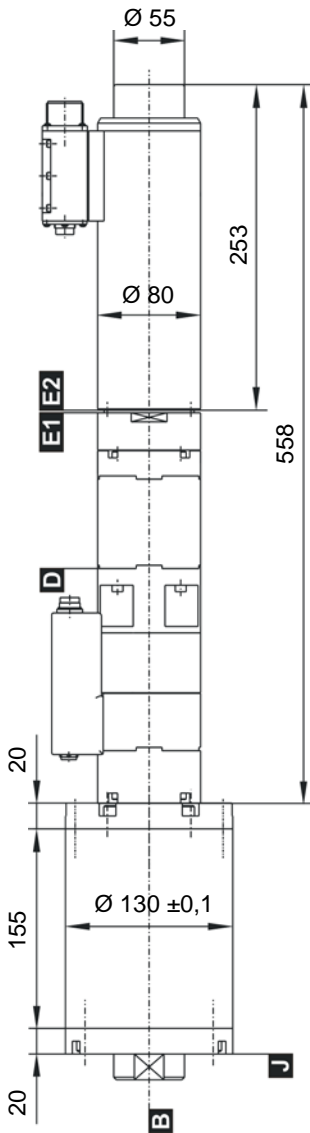

DS 80-130 SA (900/1000 Nm)

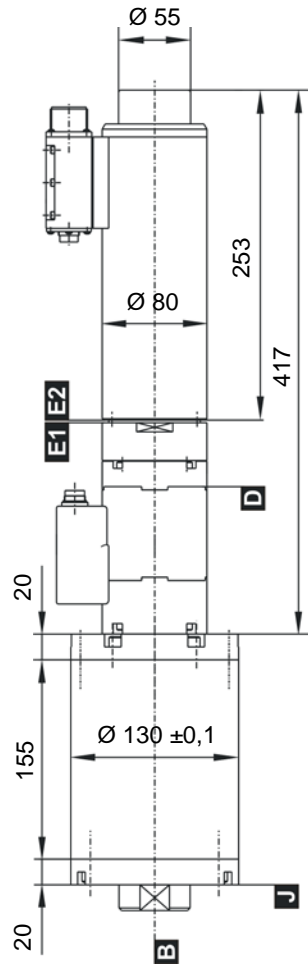

DS 80-130 MDW (1500/2000/2400 Nm)

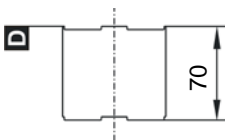

Additional
2nd gear stage
(Booster gear unit)

DS 80-130 SA (1500/2000/2400 Nm)

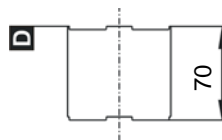

Additional
2nd gear stage
(Booster gear unit)

Mounting flange

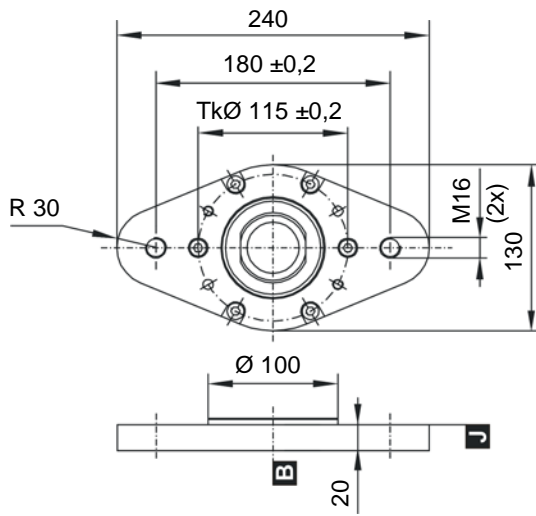

Spring output

